



T&S BRASS AND BRONZE WORKS, INC.
 2 Saddleback Cove / P.O. Box 1088
 Travelers Rest, SC 29690

Model No.
MV-1907-12CW

Item No.

Travelers Rest, SC: 800-476-4103 • Simi Valley, CA: 800-423-0150 • Fax: 864-834-3518 • www.tsbrass.com

This Space for Architect/Engineer Approval

Job Name _____ Date _____
 Model Specified _____ Quantity _____
 Customer/Wholesaler _____
 Contractor _____
 Architect/Engineer _____

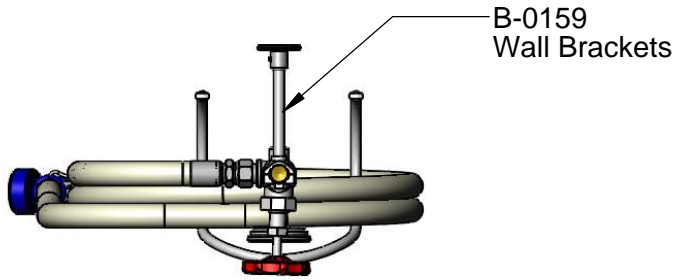

Adjustable from
 1 1/4" to 6"
 [32mm to 152mm]

3/4" Supply Piping
 by Others

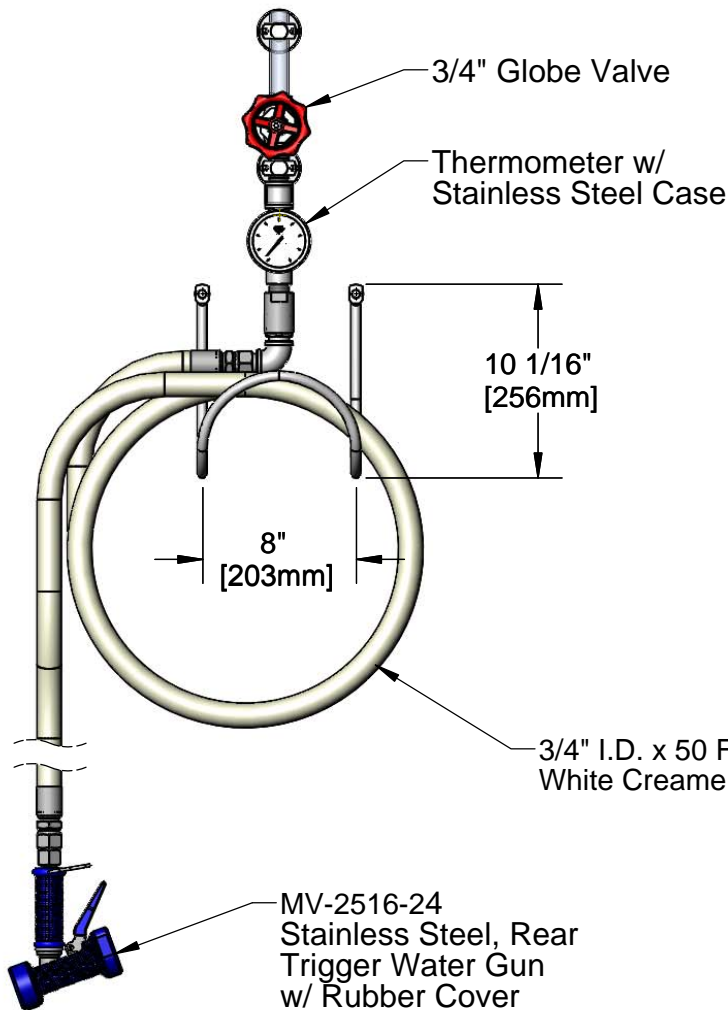
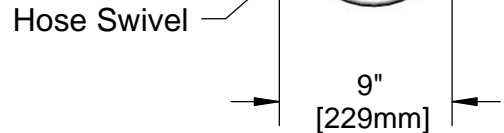
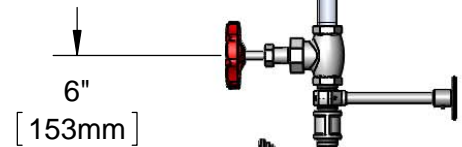

Product Specifications:
 Chrome Plated Washdown Station w/ 3/4" Inlet, Single Service Valve,
 Thermometer, 50 Ft. Hose, Stainless Steel Water Gun & Hose Rack

Product Compliance:
 NSF 61 Exempt (Non-Potable)



T&S BRASS AND BRONZE WORKS, INC.
 2 Saddleback Cove / P.O. Box 1088
 Travelers Rest, SC 29690

Model No.
MV-1907-12CW

Item No.

Travelers Rest, SC: 800-476-4103 • Simi Valley, CA: 800-423-0150 • Fax: 864-834-3518 • www.tsbrass.com

ITEM NO.	SALES NO.	DESCRIPTION
1	B-0159	6" Wall Bracket
2	006648-25	3/4" Globe Valve
3	003799-45	Thermometer, Bi-Metallic
4	004980-40	50' of 3/4" Hose w/ Adapters
5	MV-2516-24	5/16" Water Gun, Rear Trigger
6	002970-45	Hose Rack w/ Mounting Hardware
7	007252-25	Swivel
8	002721-45	O-Ring

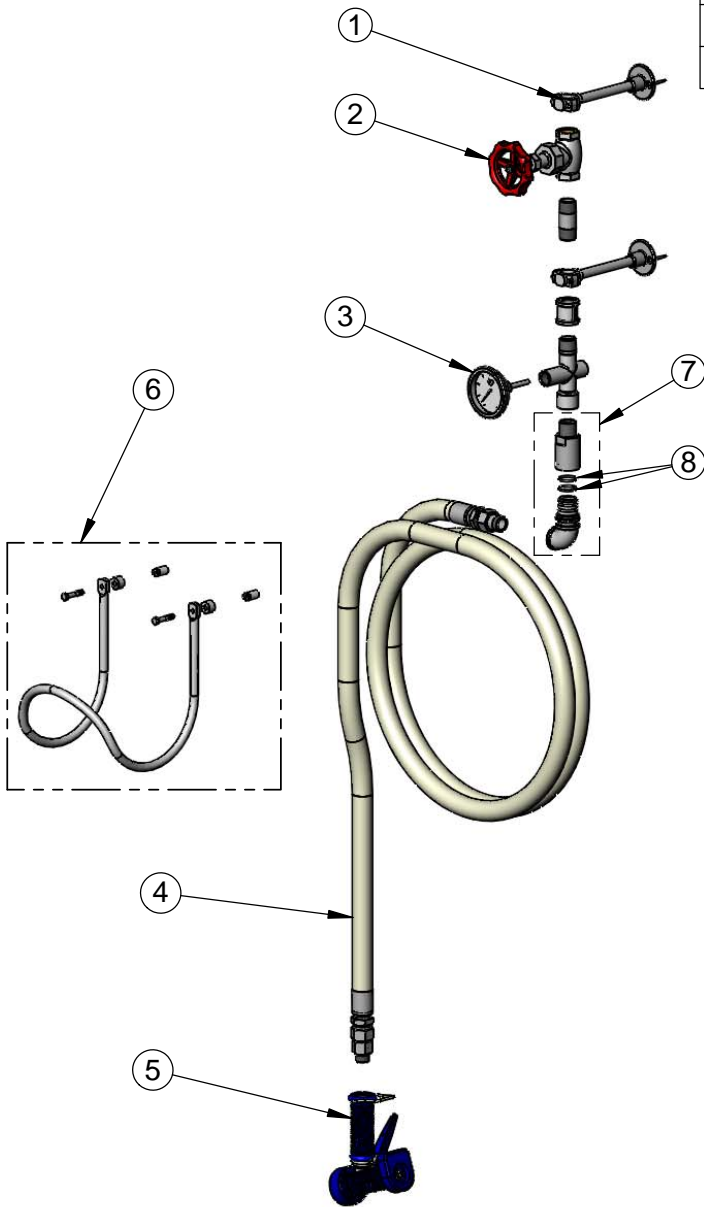

Product Specifications:
 Chrome Plated Washdown Station w/ 3/4" Inlet, Single Service Valve,
 Thermometer, 50 Ft. Hose, Stainless Steel Water Gun & Hose Rack

Product Compliance:
 NSF 61 Exempt (Non-Potable)